

11 EH1200 DRIVE ASSEMBLY PARTS LIST

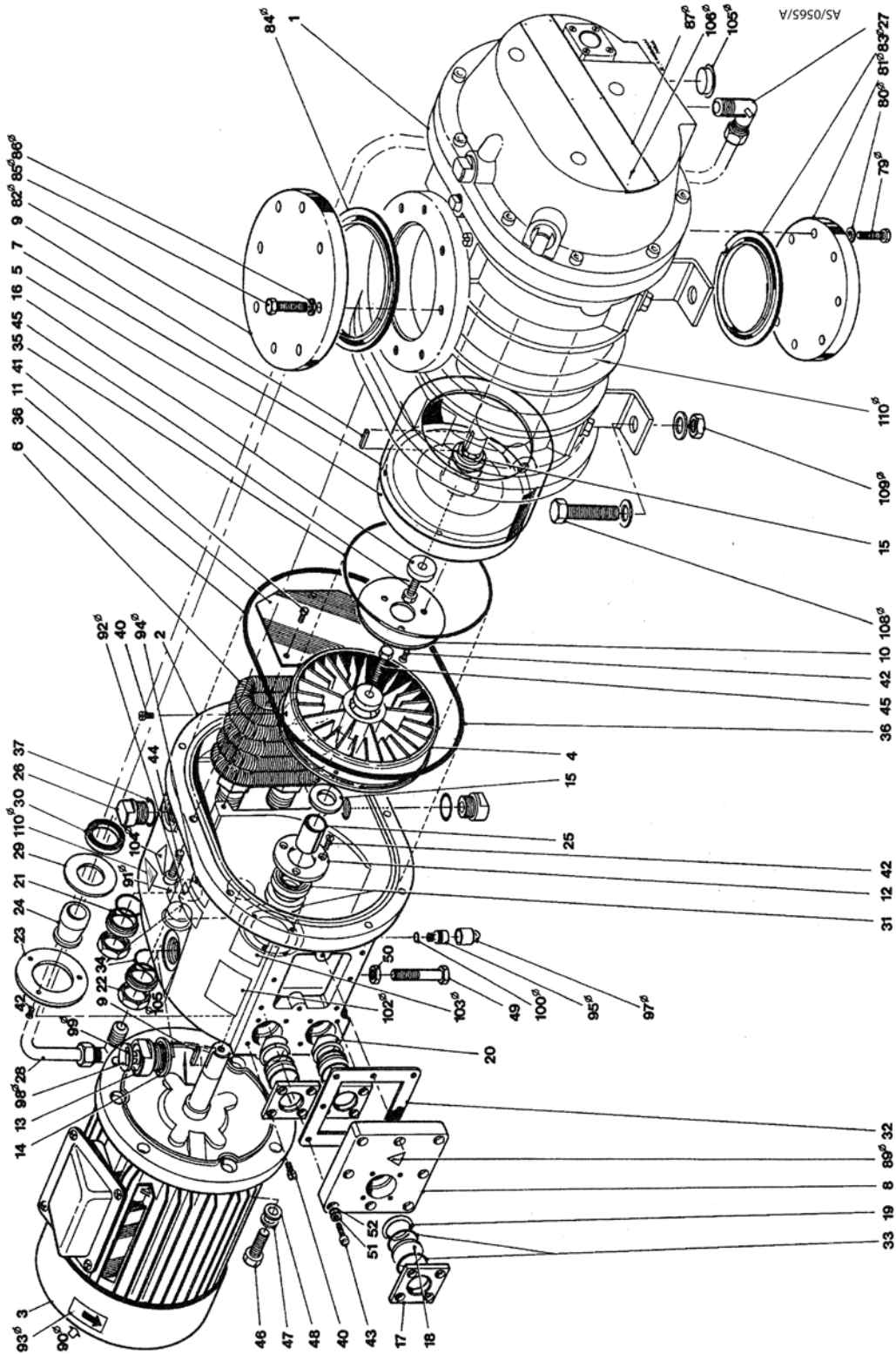

Figure 10 - EH1200 Drive assembly

Ref.	Description	Product Quantity	Item Number	Kit No.(s)
001	EH1200 pump module	1	A30530000	
002	Coupling cover	1	A30551028	
003	Drive	1	See Table 15	
004	Fluid coupling (driver) (ali)	1	A30551030	
005	Fluid coupling (driven) (ali)	1	A30551031	
006	Coupling cover cooling coil assy (copper)	1	A30551010	
007	Coupling enclosure (ali)	1	See Table 15	
008	Cover plate (stl)	1	A25942016	
009	Key 8 x 7 x 25 lg (stl)	1	A24301025	
010	Coupling baffle (stl)	1	A25970010	
011	Oil reservoir cover (stl)	1	A25970011	
012	Seal retainer (stl)	1	A25971005	
013	1" Gas plug with vent (stl)	1	A26002041	
014	1" BSP Dowty washer(rubber)	1	H02104008	
015	Thrust ring (stl)	2	A26407006	
016	Thrust ring (stl)	2	A26407005	
017	Sight glass bezel (plast)	3	A25908100	
018	Sight glass (glass)	3		5,6
019	Compression ring (m stl)	3	A27820008	
020	Sight glass reflector (st stl)	2	A25976001	
021	Cooling coil spacer (stl)	2	A27802003	
022	3/4" BSP hex locknut	2	A25971028	
023	Seal retainer (stl)	1	A27802036	
024	Sleeve (hardened)	1	A27802031	
025	Straight sleeve	1		
026	1/2" BSP plug (stl) - EH1200IND & EH1200	1	A26002021	
	Filler plug purge adaptor - EH1200C & T160	1	A30555005	
027	Male stud elbow 12mm o/d x 3/8" BSPT (brass)	2	H03505111	
028	Water pipe (Copper)	1	A30585044	
029	Seal ring (rubber)	1		6
030	Seal 35 x 47 x 7 (Viton)	1		6
031	Seal 30 x 42 x 7 (Viton)	2		5,6
032	Gasket (rubber)	1		5,6
033	'O' ring 1.234" i/d x 0.139" section (Viton)	6		5,6
034	'O' ring 1.046 i/d x 0.139 section (Viton)	2		5,6
035	'O' ring 174.5 i/d x 3.0 section (Viton)	1		5,6
036	'O' ring 299.3 i/d x 5.7 section (Viton)	1		5,6
037	'O' ring 19.5 i/d x 3.0 section (Viton)	2	23714-034	
040	Std pan hd scr M5 x 10 (st stl)	18		
041	Std hex hd scr M5 x 10 (m stl)	4		
042	Std csk hd scr M5 x 10 (m stl)	9		

Table 10 - EH1200 Drive assembly parts list

Ref.	Description	Product Quantity	Item Number	Kit No.(s)
043	Std ht cap hd scr M5 x 20 (m stl)	9		
044	Std ht cap hd screw M8 x 25 (stl)	10		
045	Std hex hd screw M8 x 30 (st stl)	2		
046	Std hex hd screw M12 x 30 (ms ni)	4		
047	Std plain washer M12 (ms ni)	4		
048	Std shake proof washer M12	4		
049	Std ms hex hd bolt M12 x 60 lg	1		
050	Std ms hex thin nut M12	1	21891412	
051	Std plain washer M5	8		
052	Std shakeproof washer M5	8		
056	Loctite 641	A/R	11753-039	
057	Loctite 222 'Screwlock'	A/R		
058	Loctite 518	A/R		
059	Fomblin PT15 (alt: Krytox 240ad)	A/R		
079 Ø	Std hex hd screw M8 x 30 (st stl)	8		
080 Ø	Std plain washer M8 (ms ni)	8		
081 Ø	Blanking flange ISO 100	1	A52908143	
082 Ø	Blanking flange ISO 160	1	A52908144	
083 Ø	Trapped 'O' ring ISO 100	1	B27158171	
084 Ø	Trapped 'O' ring ISO 160	1	B27158172	
085 Ø	Std hex head scr M10 x 35 (ms ni)	8		
086 Ø	Std plain washer M10 (ms ni)	8		
087 Ø	Label (ali)	1	A20001218	
089 Ø	Warning label (plast)	1	A20001200	
090 Ø	Warning label 'Electrical' (plast)	1	E20001063	
091 Ø	Warning label 'Hot surface' (plast)	1	A20001148	
092 Ø	Label 'Do not overfill' (plast)	1	A20001209	
093 Ø	Label 'Direction of rotation' (plast)	1	A20001085	
094 Ø	Label 'Fomblin only' (plast)	1	A20001275	
095 Ø	Indicator assembly oil (m stl)	1	A30151022	
097 Ø	Modified cap (rubber)	1	A30151024	
098 Ø	Insert oil filler plug (plast)	1	A25908035	
099 Ø	Label 'Vented' (plast)	1	A20001195	
100 Ø	'O' ring size ref 0111-16 (Viton)	1	H02122009	
102 Ø	Shaft seal reservoir label (plast)	1	A20001240	
103 Ø	Label 'Coupling-cover filler plug' (plast)	1	A20001241	
104 Ø	Warning label 'Lifting' (plast)	1	A20001171	
105 Ø	Redcap plug AQ330-12 (plast)	2	H01503021	
106 Ø	Rivet (ali)	6	211430301	
108 Ø	Std hex head scr M16 x 60 lg (stl)	4		
109 Ø	Std hex nut M16	4		
110 Ø	Warning label 'Hot surface'	3	A20001286	

Table 10 - EH1200 Drive assembly parts list (continued)

12 QMB1200 DRIVE ASSEMBLY PARTS LIST

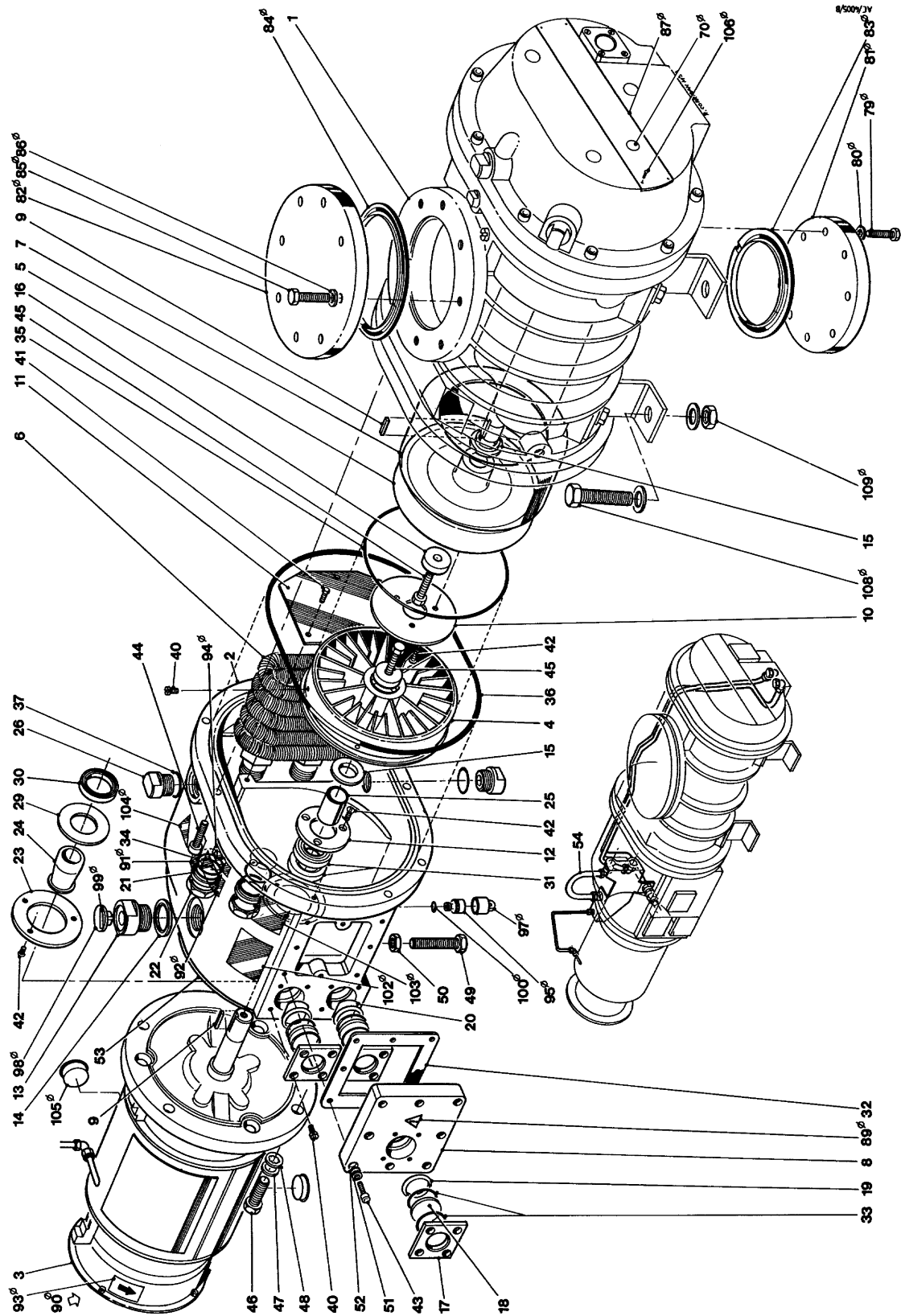

Figure 11 - QMB1200 Drive assembly

Ref.	Description	Product Quantity	Item Number	Kit No.(s)
001	EH1200 pump module		A30530000	
002	Coupling cover (c iron)	1	A30551028	
003	Drive 4hp	1	See Table 15	
004	Fluid coupling (driver) (ali)	1	A30551006	
005	Fluid coupling (driven) (ali)	1	A30551007	
006	Coupling cover cooling coil assy (copper)	1	A30551010	
007	Coupling enclosure (ali)	1	See Table 15	
008	Cover plate (stl)	1	A25942016	
009	Half key (stl)	2	A24301025	
010	Coupling baffle (stl)	1	A25970010	
011	Oil reservoir cover (stl)	1	A25970011	
012	Seal retainer (stl)	1	A25971005	
013	1" Gas plug with vent (stl)	1	A26002041	
014	1" BSP Dowty washer (rubber)	1	H02104008	
015	Thrust ring (stl)	2	A26407006	
016	Thrust ring (stl)	2	A26407005	
017	Sight glass bezel (plast)	3	A25908100	
018	Sight glass (glass)	3		5,6
019	Compression ring (stl)	3	A27820008	
020	Sight glass reflector (stl)	2	A25976001	
021	Cooling coil spacer (stl)	2	A27802003	
022	3/4" BSP hex locknut (stl)	2	M01500011	
023	Seal retainer (stl)	1	A25971028	
024	Sleeve (hardened) (stl)	1	A27802036	
025	Straight sleeve (stl)	1	A27802031	
026	1/2" BSP plug (stl)	2	A26002021	
029	Seal ring (rubber)	1		6
030	Seal 35 x 47 x 7 (Viton)	1		6
031	Seal 30 x 42 x 7 (Viton)	2		5,6
032	Gasket (rubber)	1		5,6
033	'O' ring 1.234" i/d x 0.139" section (Viton)	6		5,6
034	'O' ring 1.046" i/d x 0.139" section (Viton)	2		5,6
035	'O' ring 174.5 i/d x 3.0 section (Viton)	1		5,6
036	'O' ring 299.3 i/d x 5.7 section (Viton)	1		5,6
037	'O' ring 19.5 i/d x 3.0 section (Viton)	2	23714-034	
040	Std pan hd screw M5 x 10 (st stl)	18		
041	Std hex hd screw M5 x 10 (ms ni)	4		
042	Std csk hd scr M5 x 10 (ms ni)	9		
043	Std ht cap hd scr M5 x 20 (stl)	8		
044	Std ht cap hd scr M8 x 25 (stl)	10		
045	Std hex hd screw M8 x 30 (st stl)	2		
046	Std hex hd screw M12 x 30 (ms ni)	4		
047	Std plain washer M12 (ms ni)	4		

Table 11 - QMB1200 Drive assembly parts list

Ref.	Description	Product Quantity	Item Number	Kit No.(s)
048	Std shakeproof washer M12 (ms ni)	4		
049	Std ms hex hd bolt M12 x 60 lg (ms ni)	1		
050	Std ms hex thin nut M12 (ms ni)	1	21891412	
051	Std plain washer M5	8		
052	Std shakeproof washer M5	8		
053	Gasket	1	A27160004	
054	Water system	1	A30585040	
056	Loctite 641	A/R	11753-039	
057	Loctite 222 'Screwlock'	A/R		
058	Loctite 518	A/R		
059	Fomblin RT15 (alt: Krytox 240 ad)	A/R		
070 Ø	Label S-Mark 10mm	1	A20001720	Pk of 50
079 Ø	Std hex hd screw M8 x 30 (stl)	8		
080 Ø	Std plain washer M8 (ms ni)	8		
081 Ø	Blanking flange ISO 100	1	A52908143	
082 Ø	Blanking flange ISO 160	1	A52908144	
083 Ø	Trapped 'O' ring ISO 100	1	B27158171	
084 Ø	Trapped 'O' ring ISO 160	1	B27158172	
085 Ø	Std hex head scr M10 x 35 (ms ni)	8		
086 Ø	Std plain washer M10 (ms ni)	8		
087 Ø	Label (ali)	1	A20001218	
089 Ø	Warning label (plast)	1	A20001200	
090 Ø	Warning label 'Electrical'	1	E20001063	
091 Ø	Warning label 'Hot surface' (plast)	1	A20001286	Pk of 25
092 Ø	Label 'Do not overfill' (plast)	1	A20001209	
093 Ø	Label 'Direction of rotation' (plast)	1	A20001085	
094 Ø	Label 'Fomblin only' (plast)	1	A20001275	
095 Ø	Oil indicator assembly (m stl)	1	A30151022	
097 Ø	Modified cap (rubber)	1	A30151024	
098 Ø	Insert oil filler plug (plast)	1	A25908035	
099 Ø	Label 'Vented	'1	A20001195	
100 Ø	'O' ring size ref 0111-16 (Viton)	1	H02122009	
102 Ø	Label 'Shaft seal reservoir' (plast)	1	A20001240	
103 Ø	Label 'Coupling-cover filler plug' (plast)	1	A20001241	
104 Ø	Warning label 'Lifting' (plast)	1	A20001171	
105 Ø	Redcap plug AQ330-12 (plast)	2	H01503021	
106 Ø	Rivet (ali)	6	211430301	
108 Ø	Std hex head scr M16 x 60 lg (stl)	4		
109 Ø	Std hex nut M16 (stl)			

Table 11 - QMB1200 Drive assembly parts list (continued)